

25

P 137 S

## Modular connectors



Modular chassis socket, 8p8c (RJ45), angular, with shielding, lower side locking and flange, for printed circuit boards

25

P 137 S

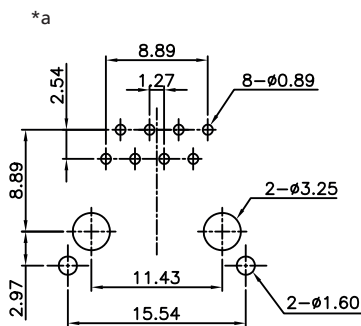
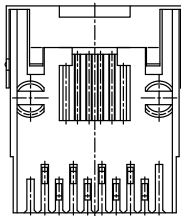
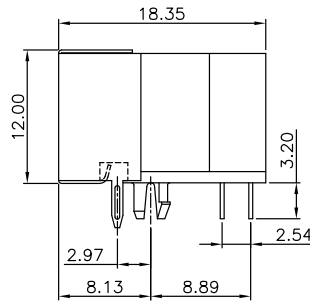
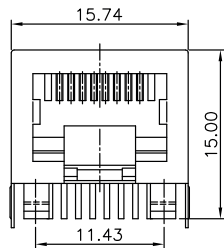

\*a printed circuit board layout, components side view

#### Environmental conditions

Temperature range 0 °C/+70 °C

#### Materials

Insulating body PBT GF, V-0 according to UL94  
Contact spring CuSn, pre-nickel and gold-plated, tin-plated in solder area  
Housing Cu alloy, tin-plated

#### Mechanical data

Mating cycles 750  
Insertion force 60 N  
Withdrawal force 60 N

#### Electrical data (at T<sub>amb</sub> 20 °C)

Contact resistance ≤ 40 mΩ  
Rated current ≤ 1,5 A  
Rated voltage 125 V  
Rated impulse voltage 500 V  
Insulation resistance ≥ 500 MΩ

#### Associated products

Counterparts  
☑ P 129 ☑ P 129 S

Accessories  
☑ 2533 01

25

P 137 S

Designation	Pole Number	PU (Pieces)	MDQ (Pieces)
P 137 S	8	38	760

**Packaging:**

in bulk, in a cardboard box or a plastic bag